



# JOBY® gorillapod®

## Operation Instructions



Rotate the rubber ring counter clock-wise to lock  the button and clock-wise to unlock. 

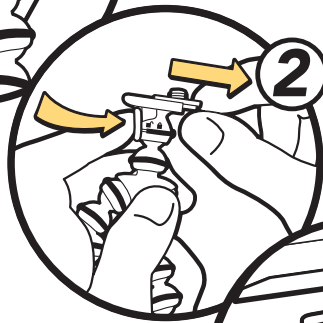

Push the button to release the clip.

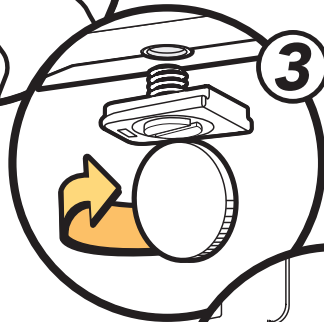

Using a coin, screw the clip into your camera.

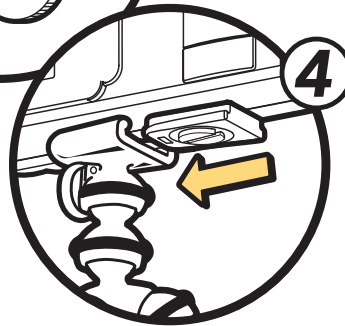

Insert clip back into Gorillapod.

**Treat your Gorillapod like you would a pet!**  
***Please DO NOT attempt the following:***

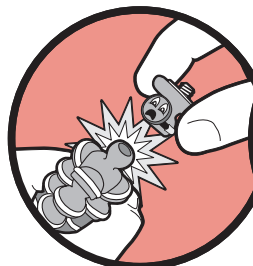

Pull your Gorillapod apart

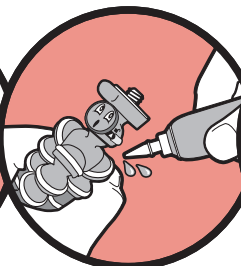

Oil or glue your Gorillapod

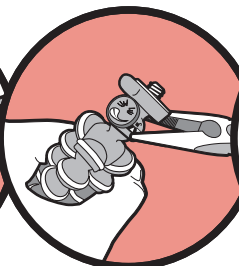

Attempt to unlock the Lock Ring with pliers

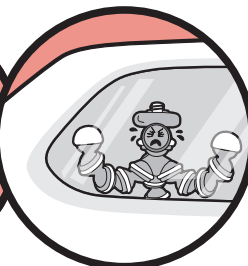

Store in a hot car or freezing cold